



# Rogers City Newsletter

## 2010 Road Construction

The major transportation routes into and out of the City of Rogers will be undergoing significant improvements beginning in the spring of 2010. These improvements will include:

- Overlay to I-94 between the Crow River and Maple Grove
- Improvements to WB I-94 on-ramp
- Improvements to SB TH 101 (main street) to EB I-94 on ramp (loop)
- Improvements to NB TH 101 (main street) to EB I-94 on ramp
- CR 81 improvements
- Improvements to WB I-94 off-ramp with flyover of South Diamond Lake Road. This project consists of construction of a new parallel exit lane on I-94 with a dual exit lane for Rogers and northbound TH 101 traffic. The new exit ramps will provide the opportunity for northbound TH 101 through traffic to go over South Diamond Lake Road prior to coming back on to TH 101, thereby making the intersection of South Diamond Lake Road and TH 101 operate more efficiently. In addition, this project will improve safety on I-94 as well as TH 101 near the South Diamond Lake Road intersection. As part of this project, a new traffic signal will be provided at the intersection of South Diamond Lake Road and Rogers Drive.

The City is working in partnership with Mn/DOT and SRF Consulting Group to complete the roadway and bridge plans and specifications, and to obtain all necessary approval by early November 2009. Upon plan approval, this project is planned to be let for construction in November in 2009, with construction beginning in early 2010, and completion by end of 2010. The City and Mn/DOT are committed to working with the business community to provide construction staging and signing, which will help limit traffic impacts to surrounding businesses. We ask for the public's patience in making these major improvements to the community. The City website will be publishing more updates when it becomes available.

## Rogers Auxiliary Oktoberfest

Rogers Fire Auxiliary presents our 2009 Oktoberfest Event on September 25th and 26th at the Rogers Community Center. Come for the food, fun and entertainment throughout the two day event.

More Information can be found at [www.rogersmnlions.org](http://www.rogersmnlions.org) or call I-94 West Chamber of Commerce at 763-428-2921

### Fall 2009

#### Issue Highlights:

Direct Payment Plan	2
2010 Budget	3
Parks & Recreation	4
Activity Center	5
Seniors	5
Liquor	6
Snow Removal Safety	6
"Ted Foss" Move Over Law	8

#### City Contact Information

City Hall	428-2253
Public Works	428-8580
Fire Dept.	428-3500
Police Dept.	428-3450
Rogers Activity Center	428-1033
Wine & Spirits	428-0163

Email: [cityhall@cityofrogers.org](mailto:cityhall@cityofrogers.org)

## Direct Payment Plan (ACH)

The City of Rogers is pleased to offer you a new service; the Direct Payment Plan (ACH). Now you can have your utility payment paid automatically from your checking account. And, you won't have to change your present banking relationship to take advantage of this service.

The Direct Payment Plan will help you in several ways:

- It saves time – fewer checks to write.
- Helps meet your commitment in a convenient and timely manner, even if you're on vacation or out of town.
- No lost or misplaced statements, your payment is always on time which helps maintain good credit.
- It saves postage.
- It's easy to sign up for, and easy to cancel.
- No late charges.

Here's how the Direct Payment Plan (ACH) works:

You authorize regularly scheduled payments to be made from your checking account. Then, just sit back and relax. Your payments will be made automatically on the due date (remember due dates have changed to the 10<sup>th</sup> of the month). Proof of payment will then appear on your mailed statement. The authority you give to charge your account will remain in effect until you notify us in writing to terminate the authorization. To take advantage of this service, complete the form below, attach a voided check, and return it to City Hall.

**The Direct Payment Plan is dependable, flexible, and convenient**

**To sign up: fill out the form, attach a voided check, and return to City Hall.**

### Automatic Pay Plan Authorization for Utility Bills

Date \_\_\_\_\_

I/we authorize the City of Rogers and the financial institution named on the attached voided check to initiate debit entries (deductions) to the account shown on the voided check.

*Please print legibly*

Financial Institution Name \_\_\_\_\_

Location (Routing ) Number \_\_\_\_\_

Account Number \_\_\_\_\_

**ATTACH A VOIDED CHECK.**

I/we understand that this authorization will continue in force unless discontinued by my/our written request.

Signature _____	(Optional – For Joint Account) Signature _____
-----------------	---

Full Name \_\_\_\_\_

Full Name \_\_\_\_\_

Daytime Telephone Number \_\_\_\_\_

## 2010 Budget Process

City Council and staff continue to work toward the goal of adopting the final 2010 budget and levy for the City of Rogers. It is the goal of both City Council and staff to continue to deliver outstanding City services to the residents and taxpayers of Rogers in the most cost-effective and efficient manner possible. While many obstacles have already been overcome through sound financial planning, budgetary reductions and other modifications, some hurdles still exist, as they do in most cities this year. For example, Rogers lost 50% of its anticipated/certified state aids (Market Value Homestead Credit) for 2008 and 100% of those aids for 2009 and 2010 as part of the Governor's budget-balancing exercise at the State level.

Options to balance the budget have been and will continue to be discussed as the budget process unfolds. Significant cuts have already been made to both the 2009 and 2010 budgets. Further budget reductions and the use of reserve funds are being considered as the first and foremost methods of balancing the budget in an attempt to limit or eliminate any potential property tax increase. Please note that, overall, City taxes account for approximately 32% of the total property tax bill for a given property, with the remaining 68% comprised of county, school district and other taxing jurisdiction levies.

By statute, the City must adopt a Preliminary Property Tax Levy by September 15, 2009, for the 2010 budget year. To that end, the City Council and staff have held numerous public work session meetings for the purposes of refining the budget. Additional meetings will occur both before and after September 15. Please note that it is the Preliminary Property Tax Levy that will be highlighted in the Notice of Proposed Property Taxes mailed to property owners in November. This is not necessarily the Final Levy that will be collected. The Preliminary Property Tax Levy as adopted in September cannot be increased by the City once established, but it may decrease when the Final Levy is adopted in December, depending upon where the Preliminary Levy is set and the results of Council work sessions between September 15 and December 31. Please contact City Hall or see the City website ([www.cityofrogers.org](http://www.cityofrogers.org)) for more information regarding meeting dates and times.

## Yard Waste

Due to Budgetary constraints, the City of Rogers has suspended paying for yard waste disposal at the Maple Grove drop site for residents effective August 1, 2009. It is understood that this is a popular service and City staff and Council hope to bring it back in the future as budgets allow.

The following are some options for disposing yard waste:

1. Pay a fee for any materials brought to the Lynde McCloud site in Maple Grove.
2. Pay a fee for any brush and yard waste brought to the Randy's Sanitation commercial drop site (5625 Quam Ave NE, St. Michael).
3. Your local garbage service may offer curbside pickup for their existing refuse customers. Please contact your local service for more information.

**Contact City Hall  
or visit the City  
website for more  
information  
regarding  
meeting dates  
and times.**

## Parks and Recreation Programs

### Adopt a Park

Adopt-A-Park is a public service program for volunteers to assist their community by picking up litter, communicating maintenance needs and assisting in improvement projects at Rogers Community Parks. It is open to community groups, civic groups, churches, families and individual citizens for a minimum of one year. Park sites are chosen on a first-come, first-serve basis. We ask that:

- Park clean-up is performed twice a month
- Pick up litter in the park area, and place the bag by the park's litter receptacle.
- Pile up fallen branches or sticks.
- Communicate any safety or maintenance concerns you see to Park staff immediately.
- Have fun volunteering in, and for, your Community!

If you have any questions or you would like to get involved in the Adopt-A-Park Program, you may contact Rogers Public Works Department at 763-428-8580.

### Rogers Photo Contest

Pull out your cameras and start taking pictures of "What Rogers Means to You". Capture the essence, as entries will be judged on how well your image conveys the theme, composition and quality of photography. All pictures must be newly taken pictures within Rogers city limits, digital, and in color. Submission of photos begins September 1 thru December 31st. Photos will be judged by photo specialists from local studios and the recreation programmer. The winner will be selected and announced after the first of the year. Contest is open to youths and adults but must be amateurs. See full contest rules at [www.parkandrec.cityofrogers.org](http://www.parkandrec.cityofrogers.org).

### Skate with Snowplow Sam and Goldy Gopher

Come and skate with some famous mascots, including Learn-to-Skate Snowplow Sam, Goldy, and U of M Hockey Cheerleaders – October 11th, 4:00 – 5:30pm during our Open Skate time.



### Farmers Market

The Rogers Farmers Market is wrapping up it's first season. The final two days are September 9th and on September 16<sup>th</sup> from 4 – 7pm, in the Rogers Activity Center Parking lot located at 21080 - 141st Ave N, Rogers, MN.

The market hosts local farmers, growers, artisans, and select Rogers' businesses to sell their own products directly to the public, allowing consumers to have a direct relationship with the producer of the items they purchase. This market emphasizes diversity, quality, and freshness and is a member of MN Grown.

Market will occur rain or shine. Market hours may be adjusted if threatening weather occurs. Please call 763-428-1033 if you have questions.

### Learn to Skate Basic Skills

The City of Rogers Learn-to-Skate group lessons focus on the benefits provided by learning through play and easy instruction. Your child will have fun while learning in a supportive, caring environment, while adults receive direct informative help in learning to skate.

Each skater will receive 25 minutes of class instruction per session, a punch card for 10 open skate sessions, a year-round membership to US-FSA Basic Skills, a skills book, and a certificate of completion. This program is a great place to start for any aspiring hockey player, figure skater, or recreational skater and helps encourage achievable levels of skater development. Each session runs for six weeks.

Cost: \$67 per skater / session

Location: Rogers Activity Center (21080 141st Ave)  
For session dates, level descriptions, level guidelines, and registration information go to [www.parkandrec.cityofrogers.org](http://www.parkandrec.cityofrogers.org).

Other Rogers' Rec program offerings and registration are available through our partnership with Community Ed at [www.728communityed.com](http://www.728communityed.com).

## Need Space to Host an Event?

Try the Activity Room at the Rogers Activity Center for your next Birthday, Graduation, Community Meeting, or Business Training Seminar!

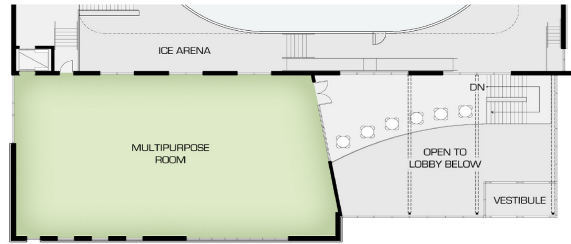

**Room Specs:** 3,000 square feet at roughly 50' x 60', 400 person capacity, 2<sup>nd</sup> Floor room accessible by stairs or Elevator. Accessories available: 80 Chairs, 14 tables (6' x 28"), Easel, Podium/Media Cart, and Projection Screen.

**Coffee Service:** Groups under 25 in attendance: \$15. Groups 25-50 in attendance: \$30 Groups 50-100 in attendance: \$50

**Booking Information:** call 763-428-1033, ext 7. or visit us on the web at: [www.rac.cityofrogers.org](http://www.rac.cityofrogers.org).

## Advertising & Sponsors Needed

Rogers Activity Center and Parks & Recreation are seeking sponsors to advertise at the ice arena and support recreational activities. Special recognition by sponsors will be noted on our web sites, at events, and other programming venues. Questions, please call 763-428-1033.

## Fall Open Skating



The Roger's Activity Center hosts fall open skating , Learn to Skate programs, skate rental, and open ice. Visit : [www.rac.cityofrogers.org](http://www.rac.cityofrogers.org) or call 763-428-1033 for more information.

## Seniors of Rogers—Hassan News

The Seniors of Rogers—Hassan have been busy with many events. We have participated in Rockin Rogers Days, the Dayton Heritage day parade, the Police department / Fire Department Open House and will be at the Otsego Festival in September.

Volunteers are always needed in order for the organization to continue and expand. Look for the monthly senior newsletter for opportunities to become involved and contact one of the board members for more information. There are currently openings for the Advisory board. Stop by or contact Rogers City Hall for more information.

Please remember that you can receive the FREE senior newsletter by mail, by email, or by visiting [www.seniors.cityofrogers.org](http://www.seniors.cityofrogers.org). The newsletter provides information on events and resources for our local seniors.

### Rental Rates

**Resident:**

**\$25/hr**

**or \$125/day**

**Non-Resident:**

**\$30/hr**

**or \$150/ day**

### **Open Skating**

**Cost:**

**Age 6 and over—**

**\$4**

**Age 5 and under-**

**FREE**

**Our website will feature a new design in Sept. Visit us at [www.rogerswineandspirits.com](http://www.rogerswineandspirits.com)**

## Liquor Department

The City Liquor Department brings a variety of value to the City of Rogers. Below are some examples of what we provide:

1. Our profits reduce your taxes. A significant portion of our profits are dedicated to the general fund-operating budget. Other revenues are used for individual projects such as carpeting, an ice machine, and a snow blower for the community center.
2. Rogers Wines & Spirits at 21725 South Diamond Lake Road and the Rogers "Muni" at 21400 John Milless Drive have partnered with local and regional organizations in successful fundraising efforts. These events have raised significant revenue for organizations in Rogers, Dayton, and St. Michael in need of funding for special projects or ongoing budgetary needs. The City of Rogers and the Rogers Liquor Department are committed to community value. Please contact us to learn more about these fundraising opportunities.
3. Rogers Wines & Spirits and the "Muni" will join other Municipal Liquor Departments in October for our second annual food drive. Last year thousands of pounds of non-perishable food items were collected across the state and distributed to local and regional food shelves. One of our industry partners, Miller Coors Brewing, provided support for this statewide project.
4. Our staff members are committed to providing great customer service with an emphasis on legal, responsible sales. Minors are not allowed in our stores without parents and are not allowed to purchase anything. We are seriously committed to public safety.

Thank you for supporting Rogers Wines and Spirits and the Rogers "Muni."

## Upcoming Snow Removal and Safety

The City of Rogers begins plowing when snowfall depth reaches at least 2" or when roadway conditions warrant a response by Public Works personnel. Equipment dispatch is dependent upon timing and intensity, weather forecast, personnel and equipment availability, and street priority classification. The primary objective is to open streets to two-way traffic beginning with arterial and collector streets and followed by local streets. Cul de sacs are generally opened by plowing the outside edge first with full clearing occurring within 24 to 48 hours.

Due to environmental concerns, sanding/salting will be limited to steep grades, high volume intersections, school crossings, or icy patches on priority routes. Trails and sidewalks within arterial and collector street corridors and those within school walking zones will be plowed when accumulation exceeds 2" in a 24-hour period.

### Sidewalks

Residents are responsible for clearing snow from sidewalks adjacent to their property within 24 hours.

**Residents are responsible for clearing snow from sidewalks adjacent to their property within 24 hours.**

## Continued, Snow Removal and Safety

### Parking

The City of Rogers would like to remind residents that there is **NO** parking allowed on any City street from November 1st to March 31st, between the hours of 2 a.m. to 6 a.m. If a vehicle is found to be parked between these hours, you could be given a citation and your vehicle may be towed.

### Winter Fun

Discourage children from building snow forts at the street edge or sliding from snow banks into the roadway. Instruct children that snow removal vehicles are dangerous, and they should move away from the road until it has been cleared and the vehicle has moved from the vicinity.

### Right-of-Way Obstructions

Items which are properly installed and allowed by ordinance to be located in the right-of-way will be considered for repair/replacement only if physically struck by a plow blade, wing, or other piece of snowplowing equipment. Trees, shrubbery, landscaping, irrigation, or other items located within right-of-way will not be considered for compensation.

### Mailbox/Paperbox

Mailboxes and paperboxes must be mounted at minimum of 46" above the street level. Properly installed mailboxes will be considered for repair or replacement with a standard residential mailbox and post only if physically struck by snowplow equipment. Installations damaged by heavy or wet snow or ice coming from the plow blade will not be repaired or replaced. The City of Rogers, Rogers Fire Department and Rogers Post Office are requesting your help in keeping the area around your mailbox clear of snow. This will enable the postal carriers to deliver your mail without delay. We are also requesting homeowners near fire hydrants help in maintaining access to the hydrants for the Fire Department should they be needed.

### Sod Damage

When streets and sidewalks are covered with snow, it is almost impossible for the snowplow operator to determine the edge of the road or sidewalk. To minimize sod damage residents may place brightly painted stakes just behind the curb or sidewalks.

### Private Property Snow Removal

State Law prohibits the placement of snow and ice from driveways in the public right-of-way. Shoveling snow/ice onto streets and highways creates unsafe driving conditions and increases the cost of snow removal.

### Winter Driving

Plows often need to slow, stop or back up, and falling, blowing, or swirling snow decreases visibility. Allow ample room between your vehicle and snow removal equipment, and always assume the driver cannot see you. Do not pass until the plow has reached a safe clear area and never pass on the right side of the snowplow vehicle. Always assume that intersections, curves, bridges, and hills are slippery and drive according to road conditions.

**November 18th  
is the average  
date for the first  
one inch  
snowfall**

**State Law  
prohibits the  
placement of  
snow and ice  
from driveways  
in the public  
right-of-way**



22350 South Diamond Lake Road  
Rogers, MN 55374

PRSR STD  
US POSTAGE PAID  
ROGERS MN  
PERMIT NO. 2

ECRWSS

## Postal Patron

**On March 26, 2009 , a Rogers Police Unit was struck on I-94. No injuries resulted in the crash, but the police unit was a total loss.**

### **“Ted Foss” Move Over Law**

Each day hundreds of Law Enforcement Officers are assisting (and citing) drivers on all sorts of roadways. Drivers often wonder what to do as they approach police vehicles on the roadway. Please remember to follow the “Ted Foss” Move over Law that is stated below:

Minnesota Statutes 169.18, subdivision 11, reads:

When approaching and before passing an authorized emergency vehicle that is parked or otherwise stopped on or next to a street or highway having two or more lanes in the same direction, the driver of a vehicle shall safely move the vehicle to a lane away from the emergency vehicle.

Some key points to remember:

- If you are traveling on a roadway with two or more lanes, you must keep a lane away when passing a stopped ambulance, fire truck, or law enforcement vehicle.
- If you are not able to safely move a lane away, reduce your speed.
- If you fail to take these actions you could receive a citation (Hennepin County Citation is \$128.00).
- Ignoring this law endangers the law enforcement officers, firefighters, emergency medical personnel, and tow truck drivers who provide critical – and often lifesaving – services on Minnesota roadways.